

PRODUCT CONFIGURATION



MX-C528F/C428F

Desktop Digital Multifunctional Document System
Single Drawer (included)

MX-C528F/C428F

The base model MX-C528F includes a 10-inch (diagonal) touch screen, and MX-C428F includes a 7-inch (diagonal) touch screen. Base models include a multitasking controller, PCL 6 and PostScript 3 compatible networking printing systems, network scanning, fax, 100-sheet duplexing single pass feeder (DSPF), auto duplexing, 550-sheet paper drawer and 100-sheet multi-bypass tray. Developer and 5K starter toner cartridges are included.

CHOOSE PAPER FEED OPTIONS

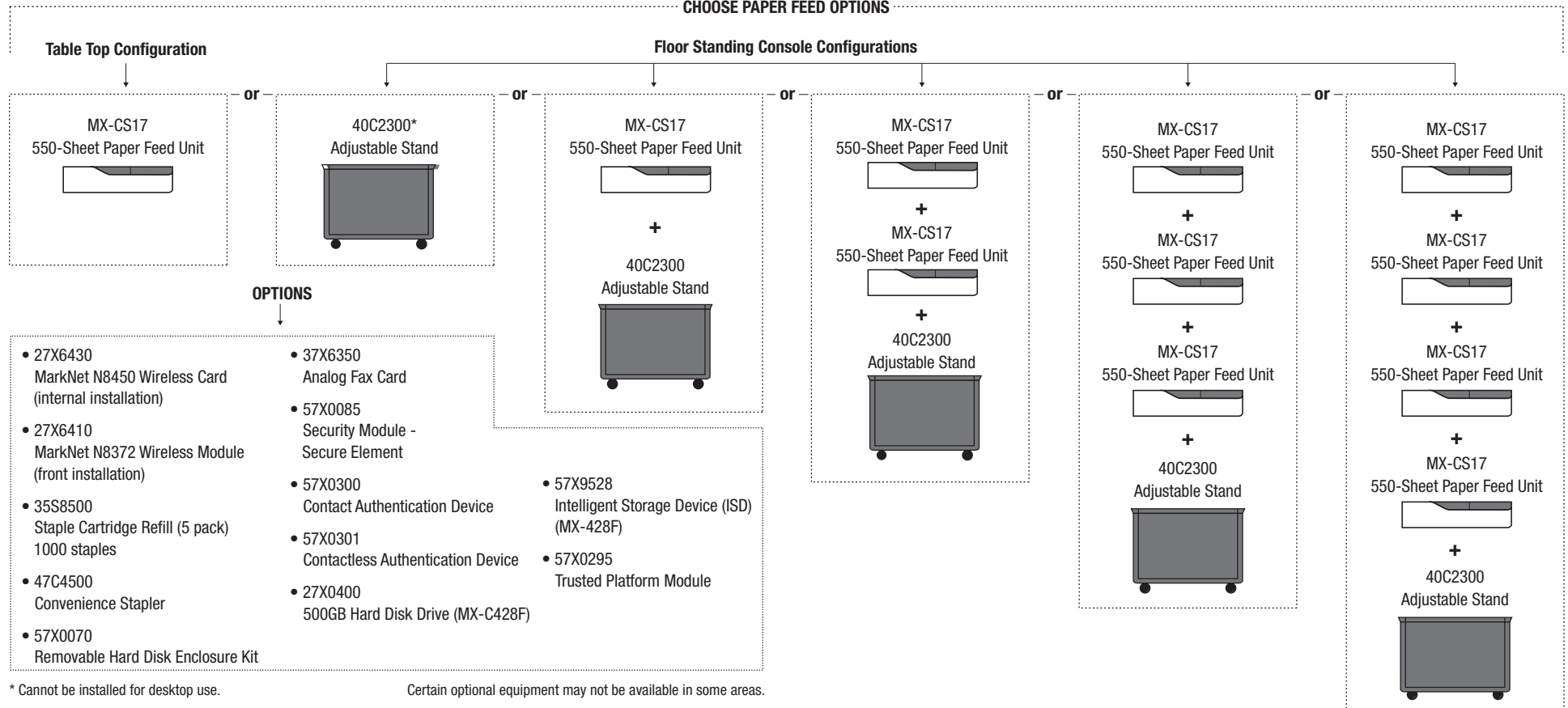

SPACE REQUIREMENTS AND PLANNING

Main Unit
(standard drawer,
table top)
650-sheet maximum

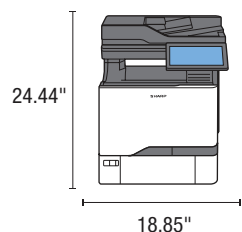

Main Unit + MX-CS17
(1 additional drawer,
table top)
1,200-sheet maximum

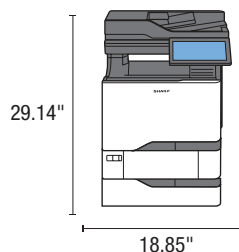

**Main Unit +
(2) MX-CS17+ 40C2300**
(2 additional drawers,
low floor standing)
1,750-sheet maximum

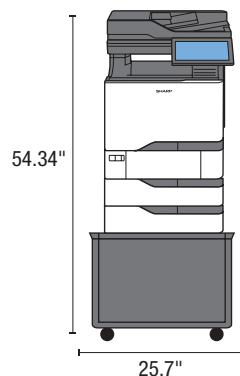

**Main Unit +
(3) MX-CS17+ 40C2300**
(3 additional drawers,
high floor standing)
2,300-sheet maximum

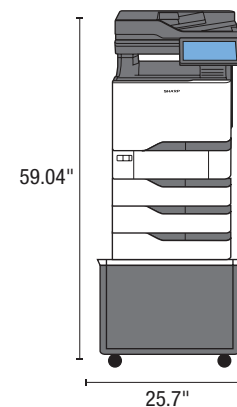

**Main Unit +
(4) MX-CS17+ 40C2300**
(4 additional drawers,
high floor standing)
2,850-sheet maximum

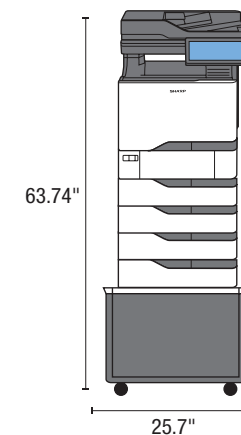

Overhead View with Stand

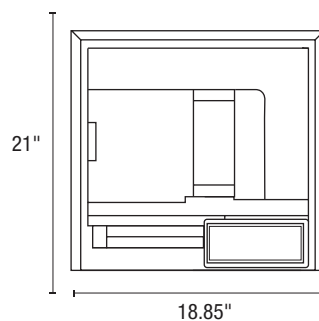

Design and specifications are subject to change without notice. All product dimensions listed are approximate.

Plan ahead to ensure your installation is a great success! Check the latest information on these products and have the following items available prior to installation.

- **Firmware:** Check the Sharp-PC Service site to make sure the machine and accessories have the latest firmware prior to installation at the customer site.
- **Power Source:** Verify the power source at the customer site. Requires 110-127 V AC @ 60 HZ with a 15 A receptacle outlet and circuit breaker.
- **Product Keys:** Obtain application codes for any accessories that may require a product key prior to arrival at the customer site.
- **Supplies:** Verify that the customer has enough supplies on hand. Starter toner included.

MX-C52TB Black Toner Cartridge
 MX-C52TC Cyan Toner Cartridge
 MX-C52TM Magenta Toner Cartridge
 MX-C52TY Yellow Toner Cartridge
 MX-C52DU-BS Black Imaging Kit (includes drum/developer)
 MX-C52DU-SS Cyan/Magenta/Yellow (includes drum/developer)