

DO A CARD SHOT COPY



1 LIFT THE COPIER'S LID AND PLACE THE CARD YOU WANT TO COPY IN THE TOP LEFT CORNER OF THE GLASS AND CLOSE THE LID



2 ON YOUR TOUCH SCREEN, TAP THE "COPY" BUTTON

3 AND SELECT "OTHERS"

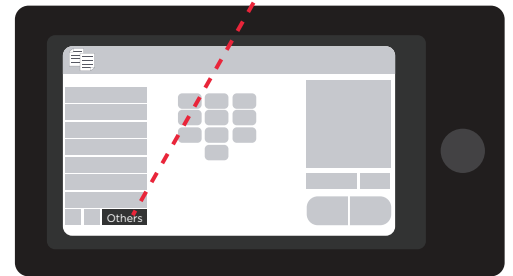

4 SELECT "CARD SHOT" FROM THE OPTIONS MENU

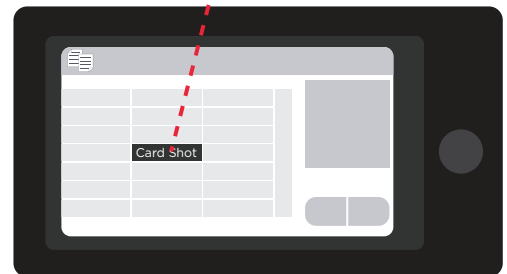

5 TOUCH THE "ON" BUTTON

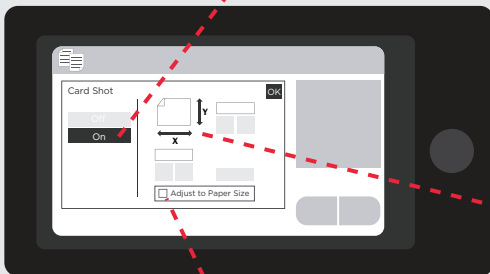

6 SELECT THE CARD SIZE MANUALLY

7 OR SELECT "ADJUST TO PAPER SIZE" AND TOUCH THE "OK" BUTTON

8 TOUCH THE "START" BUTTON

9 YOU WILL BE PROMPTED TO "PLACE YOUR NEXT ORIGINAL". YOU CAN EITHER FLIP YOUR CARD OVER AND PRESS "START" (DO THIS AS MANY TIMES AS YOU'D LIKE UNTIL YOU'RE FINISHED), OR PRESS "READ-END" IF YOU'RE FINISHED